

Mapping Utilities

...complete measurement solutions for *total* peace of mind...

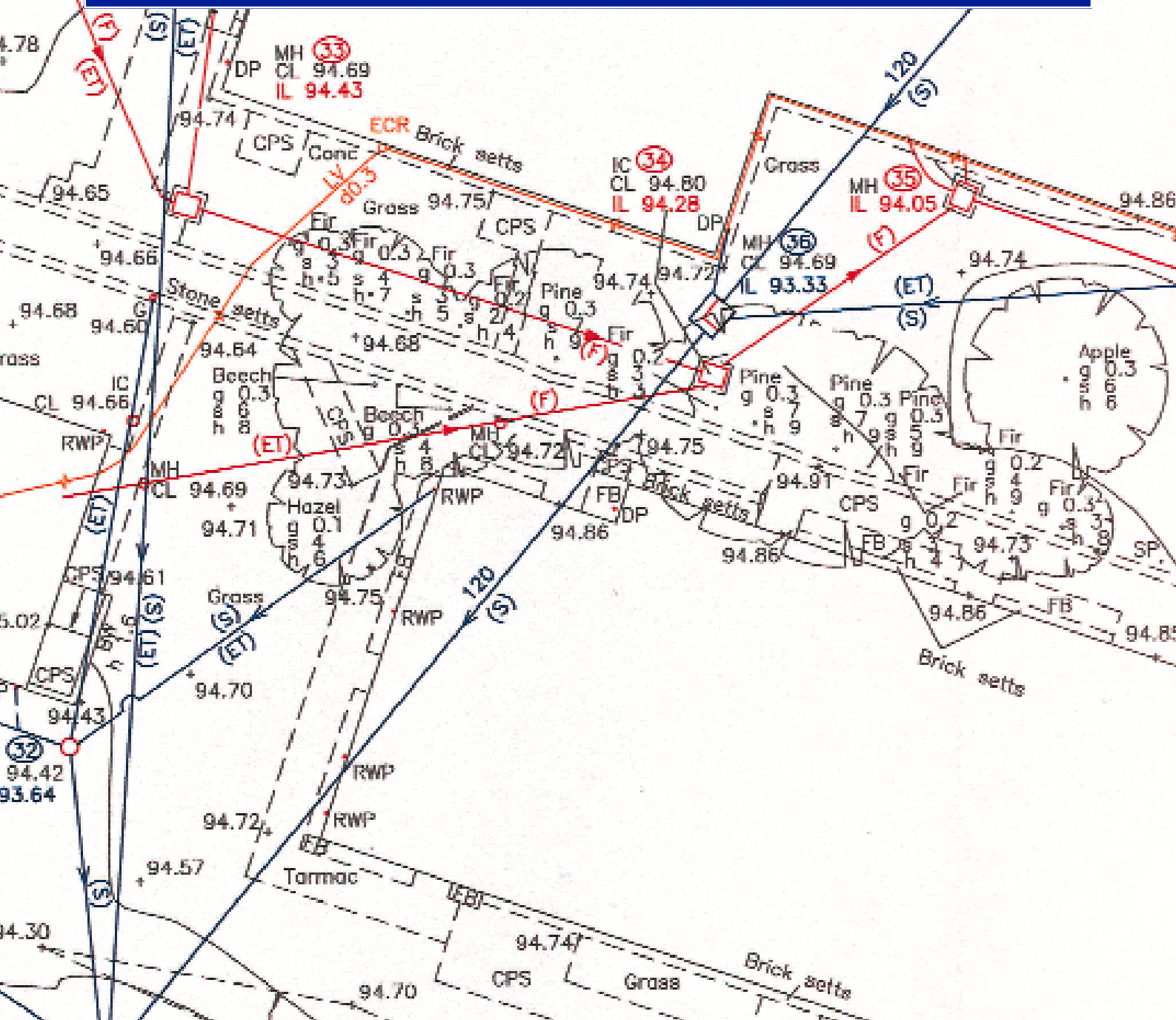

Plowman Craven

Mapping Utilities

Sewers, water, gas, electricity, telecoms – the provision of efficient and affordable utilities, for both business and the community as a whole, is a major issue of our times.

Time was when the phone company would dig up the road one day only for the gas people to come along and dig it up the next! Today, however, there has developed a more sensible co-ordinated approach.

It's all the more essential then that the providers of such services know exactly where their supply pipes and the like are located.

Enter Plowman Craven, Europe's leading geomatics company. Measurement is their business, using the **latest digital laser scanning** and GPS surveying technology and working in both 2D and, where required, 3D to give a truly **accurate picture** of the **infrastructure** on which we all depend.

With over 40 years experience and a highly skilled and motivated staff of nearly over 150 and growing, the company's vast expertise includes the surveying of proposed gas and oil pipeline routes and together with the accurate location of existing electric power cable routes, telecoms, water and gas pipes surveys and as well as sewer surveys. surveys,

“ Wind farm and radio and mobile

phone antenna surveys are another growth business for us,” says Russell Haythorpe of the company's site services team.

“Our unique selling points not only include the most sophisticated equipment available but a team whose depth of experience is enhanced by an ongoing advanced training programme at our own dedicated training centre.”

Based in Harpenden, Herts UK, Plowman Craven works for many of Europe's leading civil engineering, construction and building development companies as well as logistics and public transport providers and even film companies and the Police Service: “We can take the measure of everything from

a packing case to a multi-storey office block,” comments Russell.

“Quick, **efficient service** and the **peace of mind** our clients get from knowing the integrity of our work have seen us entrusted with **multi-million pound projects** but our bespoke personal service means we can also provide the same high standards for small-scale projects like the accurate setting out of a one-off wind turbine.

“Our company has an **international dimension** too, with field work carried out at locations around the world, from plotting an oil pipeline across Ethiopia in blistering heat to three weeks in temperatures as low as minus 25° working on the Central Russian Plain.”

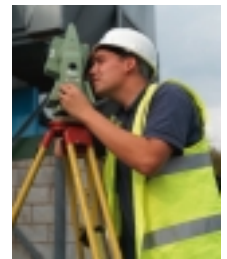
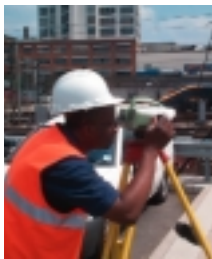

- Area Referencing
- Legal Services
- Asset Management
- Facilities Management
- Engineering Surveys
- Topographical Surveys
- View Verification
- GPS Consultancy
- Measured Building Surveys
- Forensic Geomatics
- Heritage Recording
- Rights of Light Surveys
- Laser Scanning
- Photogrammetric Measurement
- 3D Modelling
- Photography



141 Lower Luton Road, Harpenden
Hertfordshire AL5 5EQ England
Telephone (01582) 765566
Fax (01582) 765370
email post@plowmancraven.co.uk
www.plowmancraven.co.uk
London Office

Telephone 020 7490 7700 Fax 020 7490 7701



Plowman Craven